

Switch - disconnecter - fuse STVD02

Technical data:

Number of poles	1p, 1p+N, 2p, 3p, 3p+N
Rated voltage	230/400 Va.c., 110 V (2p) d.c.
Rated breaking capacity	50 kA
Rated insulation voltage	400 V
Rated impulse resistance voltage	6000 V
Category of use according to DIN VDE 0638	AC 22(63 A), AC 23(35 A), DC 22 (63 A)
Category of use according to DIN E 60 947-3	AC-22A (63A/400V a.c.), AC-23A (35A/400V a.c.), DC-22B (63A/110V d.c.)
Mechanical life	8.500 cycles
Electrical life	1.500 cycles
Temperature of environment	-5°C to +40°C
Air humidity	90%
Degree of protection	IP 00 according to DIN 40 050
Standards	VDE 0638 EN 60 947-3, DIN VDE 0113, DIN VDE 0110
Connection clamps	Up to 35 mm ² (multiwire conductor) with screw +/-
Possibility of sealing	in ON or OFF position

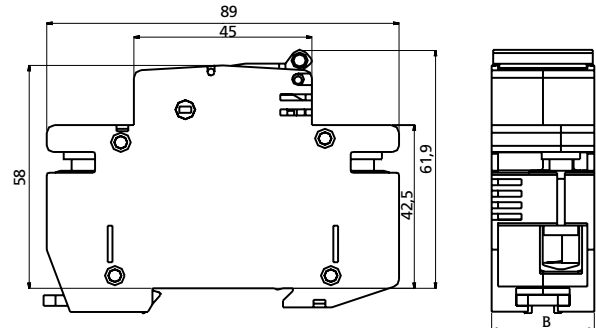

type	B [mm]
1p	26,8
1p+N	53,6
2p	53,6
3p	80,4
3p+N	107,2

Auxiliary switch PS STV

Technical data:

Rated current I _n	AC12 (6A/230V a.c.)
	DC12 (1A/110V d.c.)
Rated conditional short circuit current	1 kA at 20 A fuse link
Standards	EN 62019

